

SITE LOCATION - N.T.S.

Lands N/F of
Peter Calhoun &
Daniel Calhoun
Deed Reel 155 Frame 1471
Tax Map Parcel 81.-1-6.1

Lands N/F of
Fernwood Place, LLC
Deed Volume 7720 Page 258
Tax Map Parcel 81.-1-5

Lands N/F of
Ana T. Pieruccetti
Deed Volume 7909 Page 158
Tax Map Parcel 81.-2-1.12

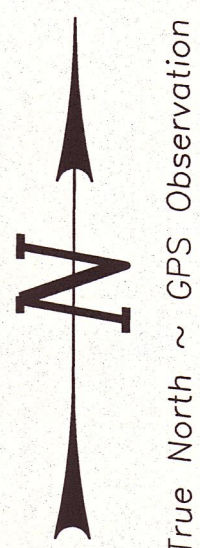

DEED REFERENCES

- 1) MAUD E. GROESBECK, WILLIAM I. MCKNIGHT, RUTH H. MCKNIGHT WINGATE, MARY E. MCKNIGHT DUNCAN & NINA G. MCKNIGHT TO FRANCIS H. MCKNIGHT & GLADYS MCKNIGHT, DATED AUGUST 19, 1964 AND FILED IN THE RENSSELAER COUNTY CLERK'S OFFICE IN BOOK 1141 OF DEEDS AT PAGE 329.
- 2) CALHOUN BROS., INC., CLARENCE CALHOUN & SARAH CALHOUN TO FRANCIS H. MCKNIGHT & GLADYS MCKNIGHT, DATED JUNE 9, 1987 AND FILED IN THE RENSSELAER COUNTY CLERK'S OFFICE IN BOOK 1455 OF DEEDS AT PAGE 342.

MAP REFERENCES

- 1) "SUBDIVISION MAP, PORTION OF CALHOUN PROPERTY, SECTION 2", PREPARED BY JAMES HOFFMAN, PE & LS, DATED AUGUST 1961 AND RECORDED IN THE RENSSELAER COUNTY CLERK'S OFFICE IN MAP DRAWER 33 AS MAP 28.
- 2) "BOUNDARY SURVEY, CALHOUN FARM, LANDS N/F OF DANIEL CALHOUN & PETER CALHOUN", PREPARED BY BRIAN R. HOLBRITTER, P.L.S., DATED DECEMBER 28, 2011, LAST REVISED APRIL 9, 2012.
- 3) "SURVEY AND MAP OF LANDS OF VINCENT A. JODICE, JR. SOUTHWEST OF LANDS OF NIAGARA MOHAWK POWER CORP.", PREPARED BY DANKIN LAND SURVEYING, LLC, DATED MAY 22, 2006, LAST REVISED AUGUST 8, 2016 AND PROVIDED AS A PROFESSIONAL COURTESY.
- 4) RENSSELAER COUNTY TAX MAP SECTIONS 81 & 81.13

NOTES

- 1) SUBJECT TO ANY/ALL EASEMENTS AND/OR UNDERGROUND UTILITIES OF RECORD.
- 2) UTILITIES SHOWN HEREON WERE AS OBSERVED AND LOCATED DURING THE COMPLETION OF FIELD SURVEY. NO RECORD PLANS WERE PROVIDED BY THE CLIENT OR BY LOCAL MUNICIPALITY TO VERIFY FIELD OBSERVATIONS. PRIOR TO FURTHER PLANNING U.F.P.O. SHOULD BE CONTACTED (1-800-962-7982) FOR THE VERIFICATION OF ANY/ALL UTILITIES WITHIN PROPOSED WORK AREA.
- 3) SURVEY PREPARED WITHOUT THE BENEFIT OF AN UPDATED ABSTRACT OF TITLE. SUBJECT TO ANY/ALL FACTS THAT MAY BE DISCLOSED.
- 4) ALL CAPPED IRON RODS SET ARE 3/8 INCH REBAR (NO. 5) WITH AN ALUMINUM CAP STAMPED "HOLBRITTER 50326 PROPERTY CORNER".
- 5) BEARING BASE SHOWN HEREON IS GRID NORTH FOR THE EASTERN ZONE OF N.Y.S. AS DETERMINED FROM GPS OBSERVATION (NAD83).

Lands N/F of
Peter Calhoun &
Daniel Calhoun
Deed Reel 155 Frame 1471
Tax Map Parcel 81.-1-6.1

Lands N/F of
Peter Calhoun
Deed Reel 152 Frame 1935
Tax Map Parcel 81.-1-8

Remaining Lands N/F of
Francis H. McKnight &
Gladys McKnight
Deed Book 1141 Page 329
Tax Map Parcel 81.-1-7
Original Area = 55.7± Acres
Remaining Area = 32± Acres

Other Lands N/F of
Francis H. McKnight &
Gladys McKnight
Deed Book 1257 Page 542
Tax Map Parcel 81.13-1-1

Lands N/F of
Robert R. Petronis &
Betty J. Petronis
Deed Book 1295 Page 112
Tax Map Parcel 81.13-1-2

Remaining Lands N/F of
Francis H. McKnight &
Gladys McKnight
Deed Book 1141 Page 329
Tax Map Parcel 81.-1-7
Area = 32± Acres
(Not Surveyed)

Lands N/F of
Ray W. McKnight &
Antoinette M. McKnight
Deed Book 1141 Page 553
Tax Map Parcel 81.-2-49
Original Area = 16.65± Acres
Revised Area = 40.34± Acres

Area = 23.69± Acres

TABLE OF ADJOINING LAND OWNERS

T.M.P.	Owner	Deed Reference	Lot #
81.13-1-3	Michael J. Cavanaugh & Jamie L. Cavanaugh	Volume 4161 Page 342	26
81.13-1-4	Robin L. Young, Trustee of the Young Family Trust	Volume 4698 Page 7	27
81.13-1-5	Darryl Lovely	Volume 6894 Page 164	26
81.13-2-1	Adam Fleming	Volume 8052 Page 235	18

LEGEND

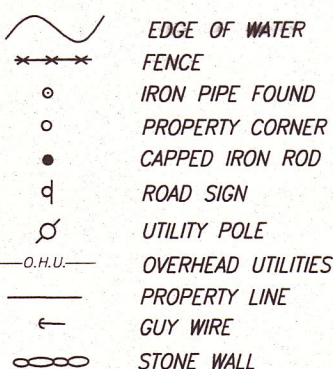

UNAUTHORIZED ALTERATIONS OR ADDITION TO THIS SURVEY MAP IS A VIOLATION OF SECTION 7209 OF THE NEW YORK STATE EDUCATION LAW. COPIES OF THIS SURVEY MAP NOT BEARING THE LAND SURVEYOR'S EMBOSSED SEAL AND SIGNED WITH RED INK SHALL NOT BE CONSIDERED TO BE VALID COPIES. CERTIFICATION INDICATED OR IMPLIED HEREON SHALL ONLY RUN TO THE PARTY FOR WHOM THE SURVEY WAS PREPARED AND ON HIS BEHALF TO THE ADDITIONAL PARTIES LISTED HEREON. CERTIFICATIONS ARE NOT TRANSFERABLE TO ADDITIONAL PARTIES OR SUBSEQUENT OWNERS NOT LISTED HEREON.

DATE	REVISIONS

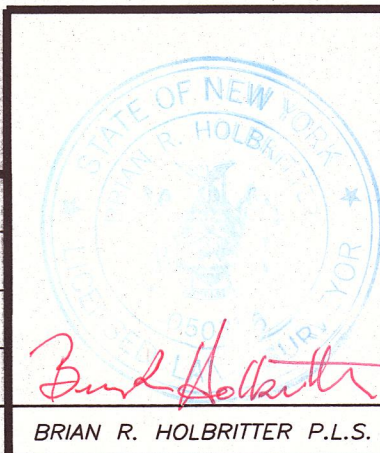

BRIAN R. HOLBRITTER

LAND SURVEYING & SITE DEVELOPMENT
34 CENTER STREET
SCHAGHTICOKE, NY 12154

PHONE: 518-753-7592
State of NY #50,326 State of VT #737

Town Approval:

Health Department Approval:

Boundary Line Adjustment Survey

Between Lands N/F of

**Francis H. McKnight &
Gladys McKnight**

& Lands N/F of

**Ray W. McKnight &
Antoinette McKnight**

TOWN OF BRUNSWICK, RENSSELAER COUNTY, NEW YORK

SCALE: 1" = 100'

FEBRUARY 20, 2020

TAX MAP PARCELS 81.-1-7 & 81.13-1-20

MAP NO. 2020-008